



LUXURY HOMES COLLECTION

AMAZINGRESULTS

THE FINEST HOMES IN THE BEST LOCATIONS

WWW.AMAZINGRESULTS.COM

82 CONTLAW ROAD *ABERDEEN, ABERDEENSHIRE AB13 0EJ*







82 Contlaw Road

In the prestigious suburb of Milltimber, Aberdeen, this detached house offers a perfect blend of elegance and functionality. Boasting 2 reception rooms, 4 bedrooms, and 3 bathrooms, this property is ideal for a modern family seeking comfort and style.

The house sits on the edge of the countryside, providing a tranquil retreat from the hustle and bustle of city life. The successful extensions over the years have created a spacious family home with a unique layout that can easily adapt to your needs.

With an impressive array of fine features, this property caters to the requirements of today's families. From the inviting reception rooms to the well-appointed bedrooms and bathrooms, every corner exudes quality and charm.

Milltimber's desirable setting adds to the allure of this residence, making it a truly exceptional find. A viewing is highly recommended to fully appreciate the beauty and high standards that define this remarkable property. Don't miss the opportunity to make this house your dream home in Aberdeen.

Fixed Price £425,000



www.AMAZINGRESULTS.com



The Property

This desirable detached residence has been successfully extended over the years providing spacious family home with a distinctive yet adaptable layout incorporating an abundance of fine features and all the requisites for today's modern family needs.

Viewing is highly recommended to fully appreciate not only the properties notable setting also the high standards that prevail throughout.

Milltimber is a prestigious suburb to the West of Aberdeen City.

Location

Milltimber is a suburb of Aberdeen, around 6 miles (10 km) west of Aberdeen city centre. Along with the nearby settlements of Cults and Bieldside, it is home to some of the wealthiest residents of Aberdeen with the nearest shop situated in neighbouring Bieldside. However, it is home to a highly rated primary school. Kippie Lodge is a sports and social club, with a 9-hole golf course, swimming pool, sports complex, creche and restaurant. Next to the lodge are the playing fields of the independent Albyn School. also ideally situated for access to the A90 Aberdeen Western Peripheral Route (AWPR) for commuting both north and south.

Entrance Hall

Entered via a modern a white UPVC and glazed door full glazed window to the front. Staircase leads to the first floor accommodation, door to cloakroom shower room, dining kitchen and bedroom/sitting room.

Sitting Room

4.27m x 3.70m (14'0" x 12'1")

The sitting room enjoys a window feature to the front. A good sized reception room and can also be an ideally used as a double bedroom as in its current use.

Cloakroom/Shower Room

Well designed cloakroom and shower room, fully tiled comprising WC, wash basin and a quadrant shower cubicle.



GROUND FLOOR



1ST FLOOR



2ND FLOOR

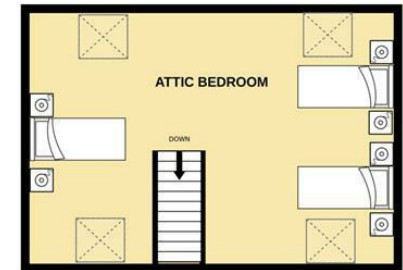

Whilst every attempt has been made to ensure the accuracy of the floorplan contained here, measurements of doors, windows, rooms and any other items are approximate and no responsibility is taken for any error, omission or mis-statement. This plan is for illustrative purposes only and should be used as such by any prospective purchaser. The services, systems and appliances shown have not been tested and no guarantee as to their operability or efficiency can be given.
Made with Metropix ©2024

Kitchen/Dining Room

8.80m x 3.50m (28'10" x 11'5")
A particularly spacious and well designed modern fitted kitchen incorporating a wide range of wall and base units, with fitted appliance to include a five ring gas hob, over head extractor, double oven, grill/microwave oven and a dishwasher. Window feature to the rear over looking the rear garden.

Utility Room

3.53m x 1.93m (11'6" x 6'3")
The utility room is accessed from the Kitchen/Dining Room. A small stair case lead down to the utility via a glazed door, comprises of a range of base units, sink space for washing machine, the gas hearing combi boiler is housed within the room, a door leads off to the rear garden and opposite door leads to the front garden.

Lounge

6.01m x 4.75m (19'8" x 15'7")
A bright and spacious family lounge with full width window feature and French doors leading off to the timber decked area and rear garden. Ceiling skylight windows allow natural light. The room is enhanced with an attractive brick fire surround and hearth with a living flame gas fire.

Upper Landing

A spacious upper landing leading access to bedroom and bathroom accommodation.

Family Bathroom

Attractively designed family bathroom comprising of WC, panelled bath and a vanity unit with two wash basins and obscure glazed which is located to the rear.

Master Bedroom

4.25m x 3.69m (13'11" x 12'1")
A good-sized double bedroom, with window feature to the front and a range of fitted wardrobes to one wall providing ample shelving and hanging space. Door to the En-Suite Shower Room.

Master Bedroom En-suite

Modern fitted shower room comprising, WC, wash basin and shower cubicle.

Bedroom Two

3.54m x 3.39m (11'7" x 11'1")
A spacious double bedroom with window feature to the front ample space for free standing wardrobes and additional bedroom furnishings, a door leads to a staircase leading to the attic bedroom.

Bedroom Three

3.28m x 2.28 m (10'9" x 7'5" m)
A double or large single bedroom with a window feature to the rear. There is adequate space for bedroom wardrobes and furnishings.

Attic room /Bedroom Four

8.0m x 5.85m (26'2" x 19'2")
Access to the attic room is gained from a staircase off bedroom

two. The attic bedroom is of generous proportions with skylight windows providing natural light to the room. There is ample space for bedroom furnishing ideally could be a bedroom or games room.

Garage

Double Garage is attached to the house.

Gardens

A sweeping curved drive way leads to the main entrance and garage. The front garden is bordered with a low-level wall with grassed area to either side of the driveway. To the rear grassed area, a timber decked area. The garden is well stocked with mature shrubs and trees including an apple tree and plum tree.

Heating and Glazing

The property is heated by a gas fired central heating system. The property is double glazed.

Interested In Viewing This Home?

Call your local Estate Agent, Ken Anderson to see this property. Viewing by appointment. 0800 999 1565 | 07585 184793.

Expert Mortgage Advice

Want to make sure you're getting the best mortgage rate? Call our expert advisers today for Fee-Free Independent Mortgage Advice and compare 1000's of great mortgages!

Get A FREE Valuation

Call 0800 999 1565 to find out how much your property is worth, or book a valuation online at AMAZINGRESULTS.com.

Awarded Scotland's 'Top Performer' by GetAgent and rated 4.8/5.0 by Google customer's reviews, we're an experienced team who you can trust to get you the best possible price for your home. Open Longer until 8pm, 7 days a week.

AMAZING RESULTS! HOME of the Professional Estate Agents.™

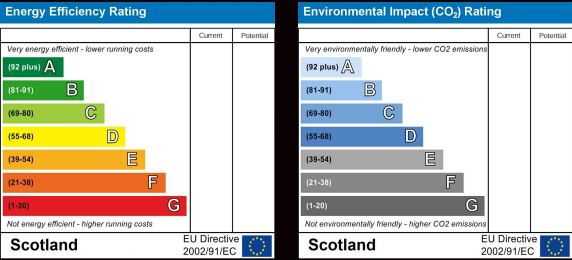



Arrange a viewing: Viewing by appointment. Please call your local Professional Estate Agent at AMAZING RESULTS!™ to see this property today on 0800 999 1565. To view additional Photographs, Floor Plans, Property Tours and Social Media content or to arrange a viewing online, please visit our website AMAZINGRESULTS.com.

What's your home worth? We have demand from buyers looking for property in your area. So why not find out how much your property is worth in today's market and let us help you keep moving. Book your free valuation with your local Professional Estate Agent online at AMAZINGRESULTS.com or call 0800 999 1565. Open until 8pm, 7 days a week.

Agents Note: AMAZING RESULTS!™ and its clients give notice that they are not authorised to make or give any representations or warranties in relation to the property either here or elsewhere either on their own behalf or on behalf of their clients. They assume no responsibility for any statement that may be made in these particulars. These particulars do not form part of any offer or contract and must not be relied upon as statements or representations of fact. Whilst every endeavour is made to ensure accuracy, any areas, measurements or distances are approximate. The text, photographs and plans are for guidance only and are not necessarily comprehensive and it should not be assumed that the property remains as photographed. It should not be assumed that the property has all necessary planning, building regulation or other consents and AMAZING RESULTS! have not tested any services equipment or facilities. Purchasers must satisfy themselves by inspection or otherwise and ought to seek their own professional advice.

The AMAZING RESULTS!™ Luxury Homes Collection. Registered Office, Dalgety House, Viewfield Terrace, Dunfermline KY12 7HY. 0800 999 1565. sales@amazingresults.com. www.AMAZINGRESULTS.com.

